

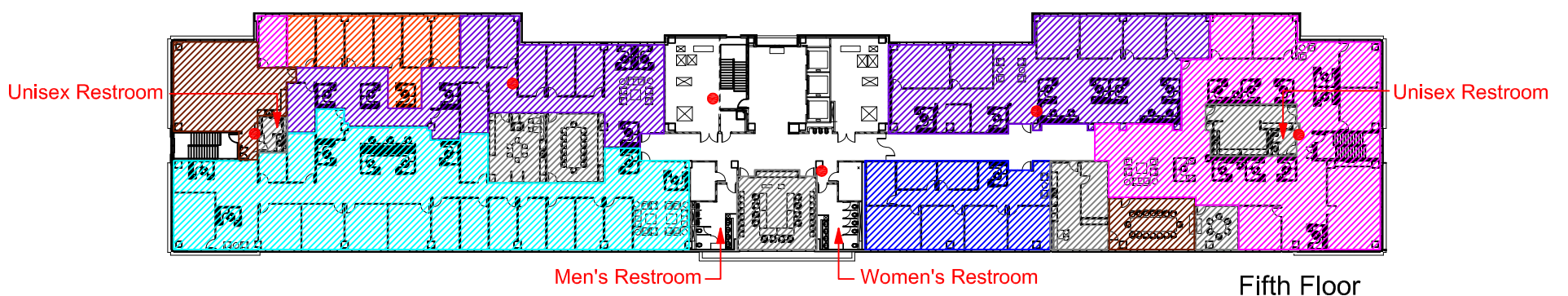

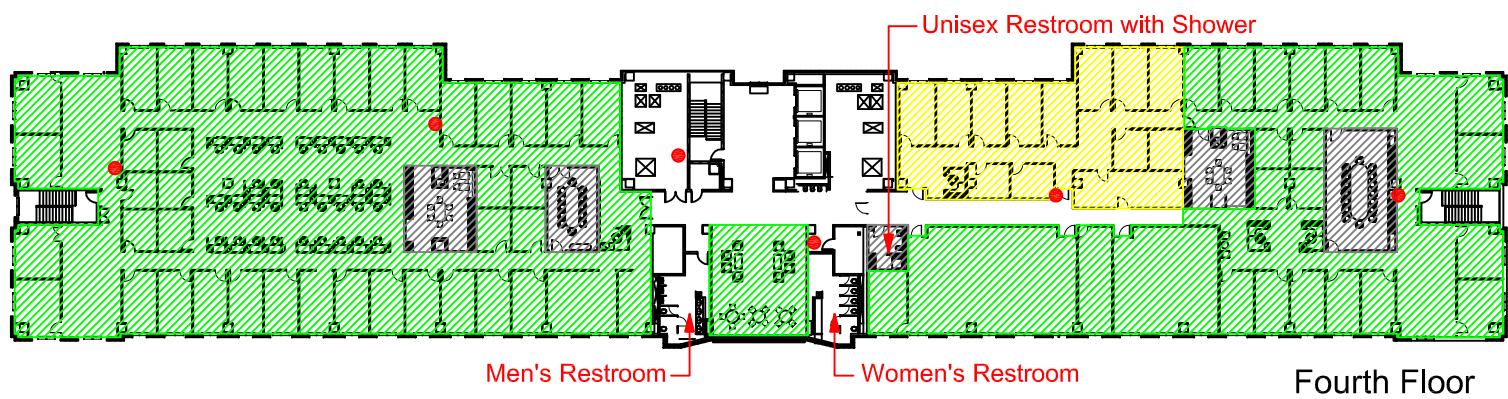

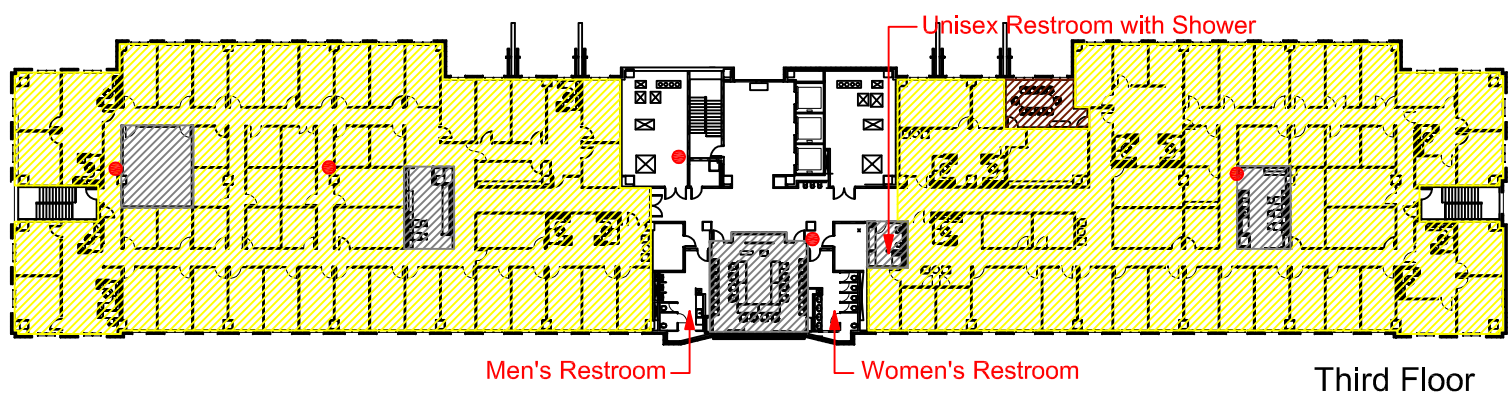

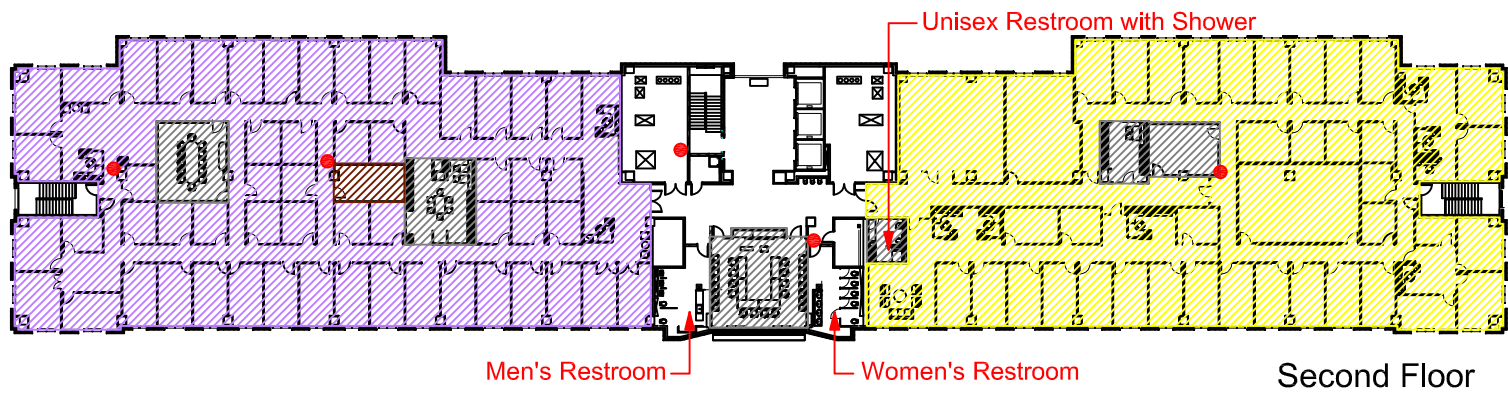

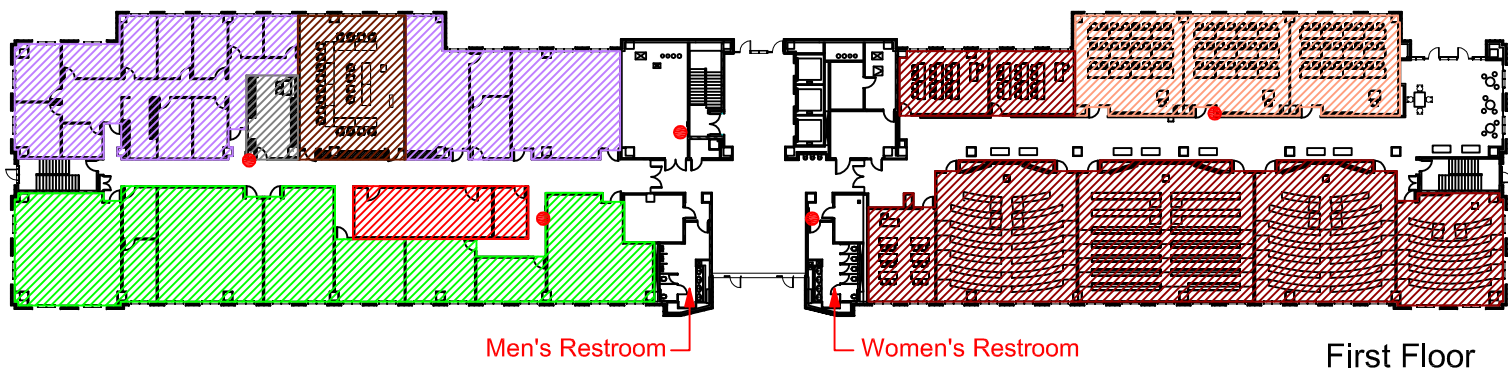



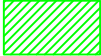
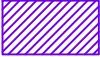

# Agriculture & Life Sciences Building



- |   |  |   |  |
|---|--|---|--|
|  | Agricultural Economics                               |  | Conference Rooms Available by Request  |
|  | Agricultural Leadership, Education, & Communications |  | Recreation, Park, & Tourism Sciences   |
|  | AgriLife Extension Service                           |  | Shared Conference & Break Rooms  |
|  | AgriLife Research                                    |  | Shared Server Room   |
|  | Classrooms   |  | Texas Agricultural Lifetime Leadership & VG Young Institute of County Government |
|  | College of Agriculture and Life Sciences             |  | Office of the Vice Chancellor  |
|  | Computer Classrooms                                  |  | Denotes Fire Extinguisher Location   |